

SERIE 400

CILINDRO DOBLE EFECTO
DOUBLE ACTING CYLINDER
DOPPELWIRKENDE ZYLINDER

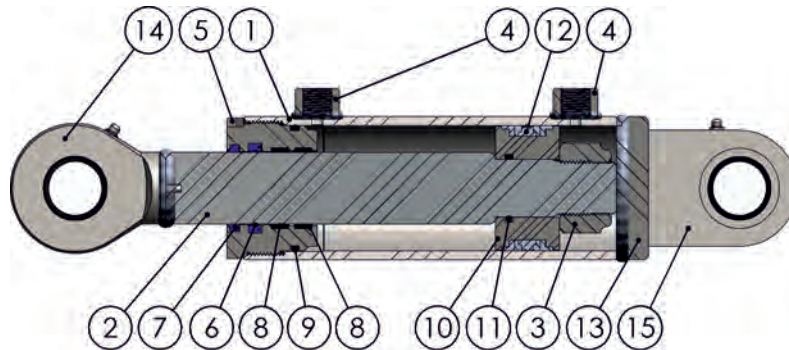

Nº pieza Part No. Part No.	Descripción Description Beschreibung	Material Material Material
1	Tubo lapeado/Cold drawn tube/Poliertes zylinderrohr	Acero - Steel - Stahl St52.3 DIN2353 h9
2	Barra cromada/Chromed rod/Verchromte kolbenstange	Acero - Steel - Stahl C45 Micron ±5 Rating 9/120h
3	Tuerca autoblocante/Lock nut/Nut	Grado - Grade - Material 8.8
4	Racor alimentación/Threaded port/Anschlussgewinde	Acero - Steel - Stahl St52.3
5	Cabeza guía D.E./D.A. bush/Kolbenstangenführung	Acero - Steel - Stahl St52.3
6	Collarín CDL/CDL rod seal/Stangendichtungen typ CDL	Poliuretano - Polyurethane - Polyrethan 93 shores
7	Rascador/Wiper/Abstreifer	Poliuretano - Polyurethane - Polyrethan 93 shores
8	Guía/guide/Führungsring	Resina acetal - Acetal resine - Polyacetal
9	Junta tórica/O-ring/O-ringe	NBR
10	Pistón OTD/OTD piston/Kolben OTD	Acero - Steel - Stahl St52.3
11	Junta tórica/O-ring/O-ringe	NBR
12	Junta pistón DAS/DAS piston seal/Kolben DAS	NBR+ POM
13	Fondo/End plug/Zylinderboden	Acero - Steel - Stahl St52.3
14	Rótula TAC/TAC ball joint /Gelenkaugen TAC	Acero - Steel - Stahl St52.3
15	Rótula TPN/TPN ball joint /Gelenkaugen TPN	Acero - Steel - Stahl St52.3

Velocidad máxima - Max. speed - Höchstgeschwindigkeit : 0,5 m/s.
Temperatura Cº - Temperature Cº - Temperaturbereich Cº : -25ºC - +80ºC.
Presión máxima - Max. pressure - Max. Druck : 250 bars.

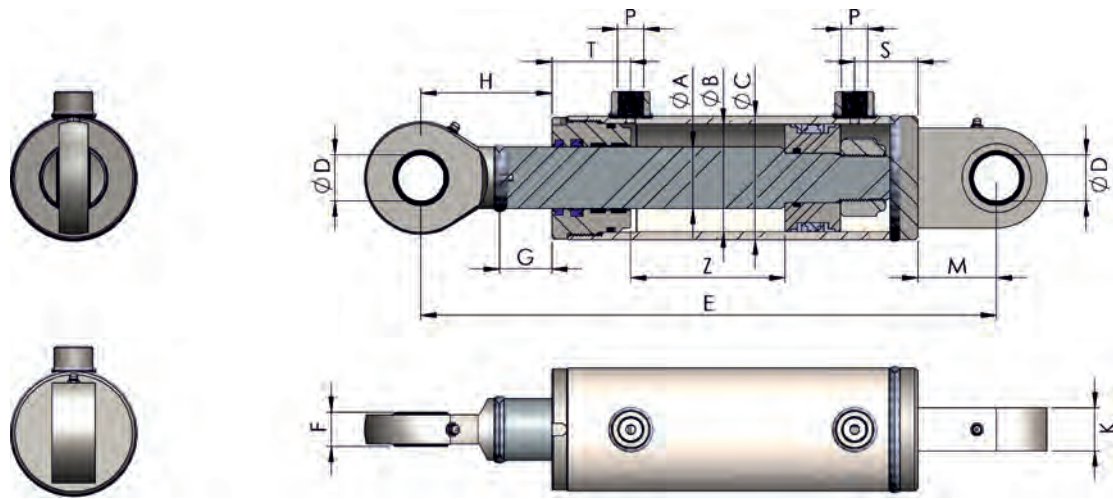

Código Code Bestell-Nr.	ØA	ØB	ØC	Z	E	ØD	P (BSP)	S	T	G	H	F	K	M	Kit juntas Seals kit Dichtsätze	Vol. (lit)	Kgs.
401_010	25	40	50	100	300	20.00 +0.00 -0.01	G3/8	29	43	7	45	16	19	38	KJDE040050025	0,13	2,65
401_020				200	400											0,25	3,55
401_030				300	500											0,38	4,45
401_040				400	600											0,50	5,35
401_050				500	700											0,63	6,25
401_060				600	800											0,75	7,15
401_070				700	900											0,88	8,05
402_010	30	50	60	100	330	25.00 +0.00 -0.01	G3/8	35	43	17	62	20	23	45	KJDE050060030	0,20	3,75
402_020				200	430											0,39	4,95
402_030				300	530											0,59	6,15
402_040				400	630											0,79	7,35
402_050				500	730											0,98	8,55
402_060				600	830											1,18	9,75
402_070				700	930											1,37	10,95
403_010	30	60	70	100	330	25.00 +0.00 -0.01	G3/8	35	47	13	58	20	23	45	KJDE060070030	0,28	4,70
403_020				200	430											0,57	6,05
403_030				300	530											0,85	7,40
403_040				400	630											1,13	8,75
403_050				500	730											1,41	10,10
403_060				600	830											1,70	11,45
403_070				700	930											1,98	12,80

Unidades en milímetros.
Units in millimeters.
Einheiten in Millimetern.

Hydraulic seals by
Aston seals



CILINDRO DOBLE EFECTO
 DOUBLE ACTING CYLINDER
 DOPPEL WIRKENDE ZYLINDER

SERIE 400

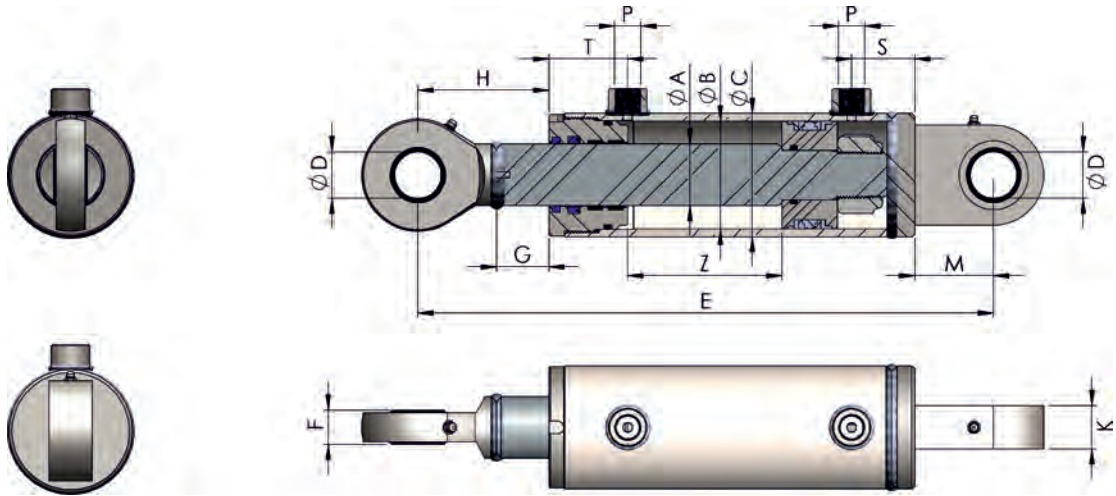

Código Code Bestell-Nr.	ØA	ØB	ØC	Z	E	ØD	P (BSP)	S	T	G	H	F	K	M	Kit juntas Seals kit Dichtsätze	Vol. (lit)	Kgs.
404_010	40	70	80	100	360	30.00 +0.00 -0.01	G3/8	41	51	21	72	22	28	51	KJDE070080040	0,39	6,75
404_020				200	460											0,77	8,65
404_030				300	560											1,15	10,55
404_040				400	660											1,54	12,45
404_050				500	760											1,92	14,35
404_060				600	860											2,31	16,25
404_070				700	960											2,69	18,15
405_010	40	80	90	100	360	30.00 +0.00 -0.01	G3/8	41	56	8	59	22	28	51	KJDE080090040	0,50	8,40
405_020				200	460											1,01	10,45
405_030				300	560											1,51	12,50
405_040				400	660											2,01	14,55
405_050				500	760											2,51	16,60
405_060				600	860											3,01	18,65
405_070				700	960											3,51	20,70
406_010	50	90	100	100	410	40.00 +0.00 -0.01	G3/8	41	60	18	87	28	35	69	KJDE090100050	0,64	11,15
406_020				200	510											1,27	13,90
406_030				300	610											1,91	16,60
406_040				400	710											2,54	19,30
406_050				500	810											3,18	22,00
406_060				600	910											3,82	24,70
406_070				700	1010											4,45	27,40
407_010	50	100	115	100	410	40.00 +0.00 -0.01	G1/2	44	66	7	76	28	35	69	KJDE100115050	0,79	15,65
407_020				200	510											1,57	19,15
407_030				300	610											2,36	22,65
407_040				400	710											3,14	26,15
407_050				500	810											3,93	29,65
407_060				600	910											4,71	33,15
407_070				700	1010											5,50	36,65

Unidades en milímetros.
 Units in millimeters.
 Einheiten in Millimetern.

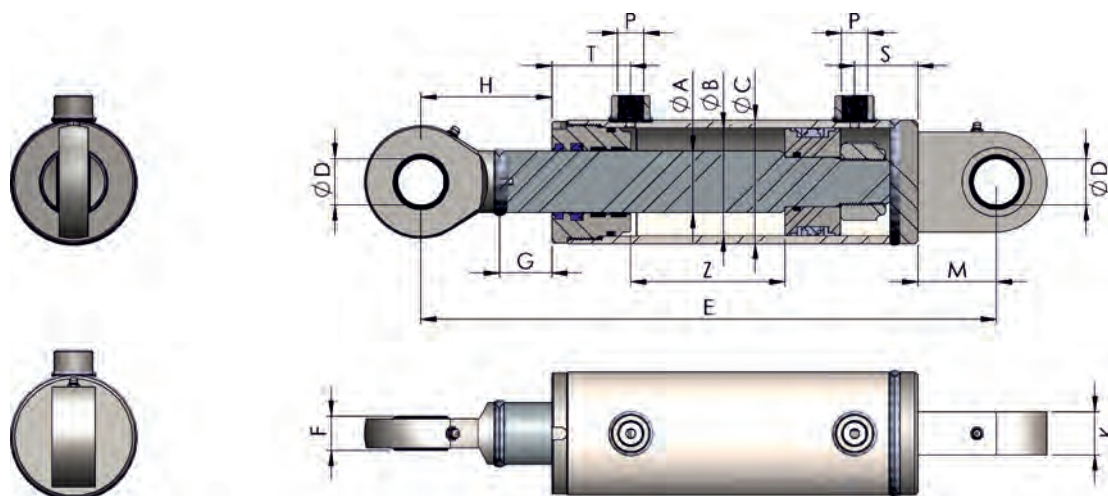

Código Code Bestell-Nr.	ØA	ØB	ØC	Z	E	ØD	P (BSP)	S	T	G	H	F	K	M	Kit juntas Seals kit Dichtsätze	Vol. (lit)	Kgs.
408_010	70	120	140	100	480	50.00 +0.00 -0.01	G1/2	50	68	22	110	35	40	88	KJDE120140070	1,13	25,50
408_020				200	580											2,26	31,70
408_030				300	680											3,39	37,90
408_040				400	780											4,52	44,10
408_050				500	880											5,65	50,30
408_060				600	980											6,78	56,50
408_070				700	1080											7,91	62,70
409_010	80	130	150	100	500	50.00 +0.00 -0.01	G3/4	50	75	20	108	35	40	88	KJDE130150080	1,33	32,15
409_020				200	600											2,65	39,50
409_030				300	700											3,98	46,85
409_040				400	800											5,31	54,20
409_050				500	900											6,63	61,55
409_060				600	1000											7,96	68,90
409_070				700	1100											9,29	76,25

Unidades en milímetros.
Units in millimeters.
Einheiten in Millimetern.

OPCIÓN // OPTION // MÖGLICHKEIT

Instalación de válvula anti-retorno, para realizar su trabajo de una forma más segura.
Installing check valve to do your work more safe.
Installieren Rückschlagventil, um ihre Arbeit sicherer machen.

